

DOUBLE & SINGLE BITTED CAM LOCKS



DOUBLE BITTED



NO. C3186

- Eleven criss-cross blade tumbler plug in $\frac{3}{4}$ " diameter.
- Die cast barrel with two flats — $\frac{5}{8}$ " across.
- Key and cam rotation 90° from locked (12 O'Clock) to unlocked (3 O'Clock) position with keypull in locked position only.
- Straight cam furnished is $\frac{1}{8}$ " thick X $\frac{3}{4}$ " wide.
- Standard finish — Polish Nickel.
- Two keys furnished per lock.

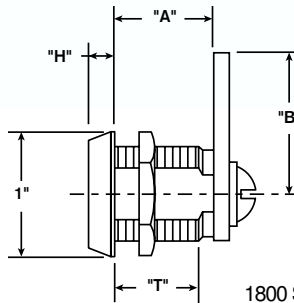

1800 SERIES

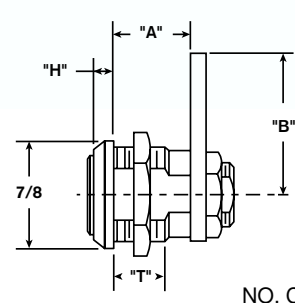

NO. C3186 & C3205

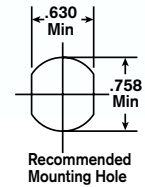

(Standard Package of 25)

Lock No.	"A" Dim.	"B" Dim.	"H" Dim.	"T" Dim.	KD	KA #2001	KA #2007	KA
C3205	$\frac{7}{16}$ "	$\frac{1}{8}$ "	$\frac{13}{64}$ "	$\frac{15}{64}$ "	99201	99202	99203	KA #2141 - 99204
C3186	$\frac{5}{8}$ "	$\frac{1}{8}$ "	$\frac{5}{32}$ "	$\frac{13}{32}$ "	99191	99192	99193	KA #781 - 99194
C1801	$\frac{13}{16}$ "	$\frac{1}{8}$ "	$\frac{13}{64}$ "	$\frac{11}{16}$ "	99084	99085	99086	KA #2141 - 99087
C1802	$\frac{11}{16}$ "	$\frac{1}{8}$ "	$\frac{13}{64}$ "	$\frac{15}{16}$ "	99096	99097	99098	KA #2141 - 99099
1803	$\frac{13}{16}$ "	$\frac{1}{8}$ "	$\frac{13}{64}$ "	$\frac{17}{64}$ "	99104	99105	99106	KA #2141 - 99107
C1804	$\frac{11}{2}$ "	$\frac{1}{8}$ "	$\frac{13}{64}$ "	$\frac{113}{32}$ "	99114	99115	99116	KA #2141 - 99117

C3205 and C3186 Available KD, KA to 2001 and 2007.

C1801 and C1804 Available KA only to 2001. C1802 Available KA to 2001 and 2007.

SINGLE BITTED



NO. C3786

- Five disc tumbler plug in $\frac{3}{4}$ " diameter.
- Die cast barrel with two flats — $\frac{5}{8}$ " across.
- Key and cam rotation 90° from locked (12 O'Clock) to unlocked (3 O'Clock) position with keypull in locked position only.
- Straight cam furnished is $\frac{1}{8}$ " thick X $\frac{3}{4}$ " wide.
- Standard finish — Polish Nickel.
- Two keys furnished per lock.

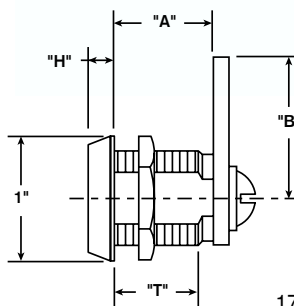

1700 SERIES

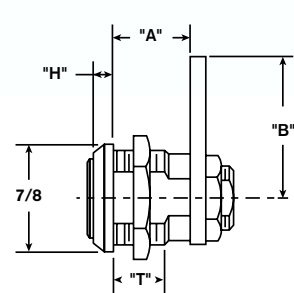

NO. 3786

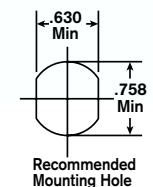

(Standard Package of 25)

Lock No.	"A" Dim.	"B" Dim.	"H" Dim.	"T" Dim.	KD	KA #1289	KA #1454
3705	$\frac{7}{16}$ "	$\frac{1}{8}$ "	$\frac{1}{4}$ "	$\frac{13}{64}$ "	99617	99618	99619
C3786	$\frac{5}{8}$ "	$\frac{1}{8}$ "	$\frac{13}{64}$ "	$\frac{13}{32}$ "	99211	99212	99213
C1701	$\frac{13}{16}$ "	$\frac{1}{8}$ "	$\frac{13}{64}$ "	$\frac{11}{16}$ "	99024	99025	99026
C1702	$\frac{11}{16}$ "	$\frac{1}{8}$ "	$\frac{13}{64}$ "	$\frac{15}{16}$ "	99034	99035	99036
C1703	$\frac{13}{16}$ "	$\frac{1}{8}$ "	$\frac{13}{64}$ "	$\frac{17}{64}$ "	99044	99045	99046
C1704	$\frac{11}{2}$ "	$\frac{1}{8}$ "	$\frac{13}{64}$ "	$\frac{113}{32}$ "	99054	99055	99056

C3786, C1703 and C1704 Available KD, KA to 1289 and 1454.

C1701 Available KA only to 1289 and 1454. C1702 Available KD and KA to 1454.

All part numbers shown in red are available through the STOCK LOCKS program.